

# Dräger Live Fire Training Mobile Unit – Containerized (MLFTU-C)

Up to two multi-prop simulators, a fold-up second story, tilt roof, generator and LPG cylinders on-board. Where price is a major concern, Dräger provides a cost-effective design for a wide variety of training exercises – mobile, where it's needed.



Dräger's containerized Mobile Live Fire Training Unit (MLFTU-C) is built using shipping containers as a back-bone, mounted on a galvanized, structural steel, drop deck trailer chassis with ISO lock mounts, landing gear and DOT lighting.

### Training area

The training area is built on approximately 300 sqft. on the lower deck 40 ft. ISO container. Walls and ceilings are insulated, steel-lined, and seal welded to make them water-proof. Ceramic insulation used is rated for 2300F. The flooring is grit-blasted providing an anti-slip surface. Replaceable sacrificial plates are installed for heat shielding around the areas directly exposed to flames.

Two doors with stairs provide access to the training area of the Dräger MLFTU-C, and are equipped with non-binding door closers. The burn room has two windows each with latched shutters, one stairway to the roof, and one additional smaller roof hatch for confined-space entry training.

### Equipment

Up to two propane fueled "multi-prop" simulators and one rollover simulator can be installed and are supplied by two DOT cylinders, 420lb each. The cylinders are located in a dedicated room and do not reduce the available space in the training area of Dräger's MLFTU-C.

The props are made from heavy gauge steel and allow to turn the 'Multi-prop' into a kitchen, sofa or bed simulator. Waterbath technology protects the equipment and effectively diffuses the propane for a truly realistic flame appearance.

Further equipment includes two automated intake fans providing combustion air and cooling, the smoke generation system with smoke fluid reservoir, and a 12kW (max.) rated generator

A vertical, removeable ladder is mounted at the rear of the unit and can be repositioned to the sides.

### Safeguards and control

The pilots, burners and ventilation are PLC controlled and designed to be fail-safe. The burner management system is designed to meet CAN/CSA B149.3 and NFPA 86.

Control feedback provided to the operator includes gas sensor readings, temperature, fan operational status and further system status monitors. The human interface to the systems allows for wireless or corded operation of the main fires. Emergency stops at all exits and at the control panel, and a dead-man switch add to the comprehensive safety of the training system.

The containerized Dräger Mobile Live Fire Training Unit (MLFTU-C) is thoroughly tested for quality assurance prior to shipment and at site.

### AFG Program

Dräger's containerized Mobile Live Fire Training Units are eligible for procurement under the Homeland Security Assistance to Firefighters Grant (AFG) Program.



**multi-prop**  
waterbath for realistic flame signature



**rollover**  
strong flame activated for 10 seconds



**streetside rear view**  
rear mounted equipment;  
optional: cladding and side ladder

## TECHNICAL DATA

### Safety

Gas detection
Temperature sensing
Flame control for pilot burners
Monitored ventilation system
Emergency stops
Dead-man switch
Waterbath protected components
PLC controlled system
Burner management system designed to: (CAN/CSA B149.3 and NFPA 86)

### Training area

Approx. 300 sqft. incl. Props
Up to 2 "multi-prop" simulators (bed, kitchen, sofa)
1 rollover simulator
2 access doors with stairs
2 windows latched with shutters
1 roof hatch
1 stairwell to the roof
1 vertical removeable ladder at rear of unit (can be repositioned to sides)
Lining seal-welded (water-proof)

### Structure

Heavy gauge steel for props
Steel lining on walls, ceiling and floor
Sacrificial plates for heat shielding
Ceramic insulation rated to 2300F
Chassis galvanized structural steel with DOT lighting, landing gear, ISO locks

### Equipment

Propane/gasoline powered 12kW (max) rated generator
2 propane cylinders (420lb each)
DOT compliant
Smoke generator, smoke fluid reservoir
2 air intake fans with automated control

### Recognized standards include:

NFPA 1402 and NFPA 1403
CAN/CSA B149 (as applicable)
NFPA 86 (as applicable)

### Options

Roof ventilation prop; tilt roof
Retractable second floor room (96 sqft.) walk-through design with 2 doors and stairwell access to lower level
Exterior cladding; provides smooth finish to ISO container sides
Moveable wall system
Folding rear staircase
Exterior scene lighting
Field inspection by an OSHA recognized 3rd party NRTL

### Available props for Multi-prop

Electric motor prop
Gas bottle rack prop
Hazardous material cabinet prop
Sofa prop (included in base model)
Bed prop (included in base model)
Kitchen prop (included in base model)

### Other available props

Wall breaching prop
Forcible entry door prop
Standpipe and sprinkler prop

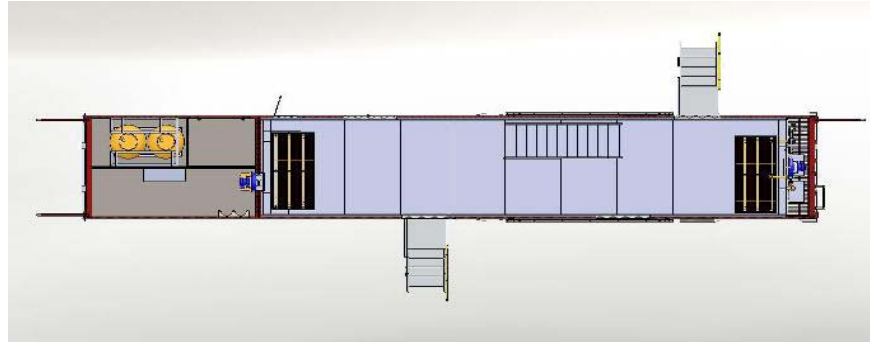

floorplan (example): MLFTU-C with 2 'Multi-prop' simulators

### Distributor of Dräger

"Concern - Energomash" CJSC  
Azatutyan avenue 26/8, Yerevan 0014, Armenia  
Tel.: 20 97 77, 20 97 75, 20 97 74  
E-mail: info@c-e.am  
www.edulab.am  
www.analytica.am, www.c-e.am